

SHIMANO XTR Mega-9 Rapidfire Lever  
**SL-M952**

For Left Hand

For Right Hand

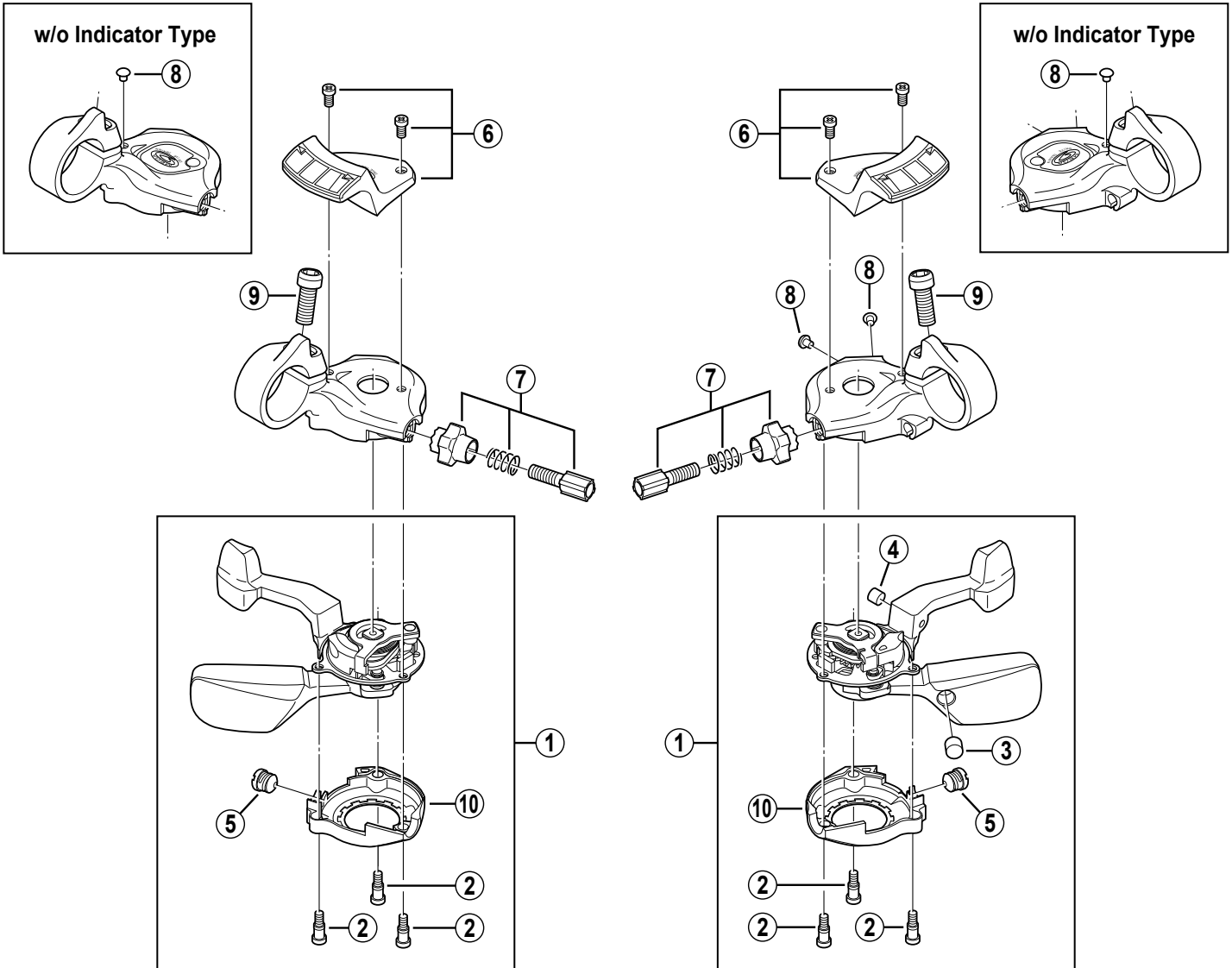

Q'TY	ITEM NO.	SHIMANO CODE NO.	DESCRIPTION
	1	<b>Y-6CF 98010</b>	R.H. Shifting Lever Unit
		<b>Y-6CF 98020</b>	L.H. Shifting Lever Unit
	2	<b>Y-6CE 37000</b>	Shifting Lever Unit Fixing Bolt
	3	<b>Y-6BV 50000</b>	R.H. Main Lever Nipple Cap
	4	<b>Y-6BV 49000</b>	R.H. Release Lever Nipple Cap
	5	<b>Y-6CD33000</b>	Inner Hole Cap
	6	<b>Y-6CF 98030</b>	R.H. Indicator Unit
		<b>Y-6CF 98040</b>	L.H. Indicator Unit
	7	<b>Y-6CE 98070</b>	Cable Adjusting Bolt Unit
	8	<b>Y-6BV 48000</b>	Base Hole Cap
	9	<b>Y-6AS 50110</b>	Clamp Bolt (M6 x 15)
	* 10	<b>Y-6CE 09100</b>	R.H. Unit Cover
		<b>Y-6CE 59100</b>	L.H. Unit Cover