

SHIMANO XTR Front Disc Brake

**BR-M965** Brake Caliper

**BR-M966** Brake Caliper  
for post type mount

**ST-M965** Dual Control Lever

**SM-RT96** Disc Rotor

**SM-BH96** Brake Hose

**SM-DB-OIL** Mineral Oil

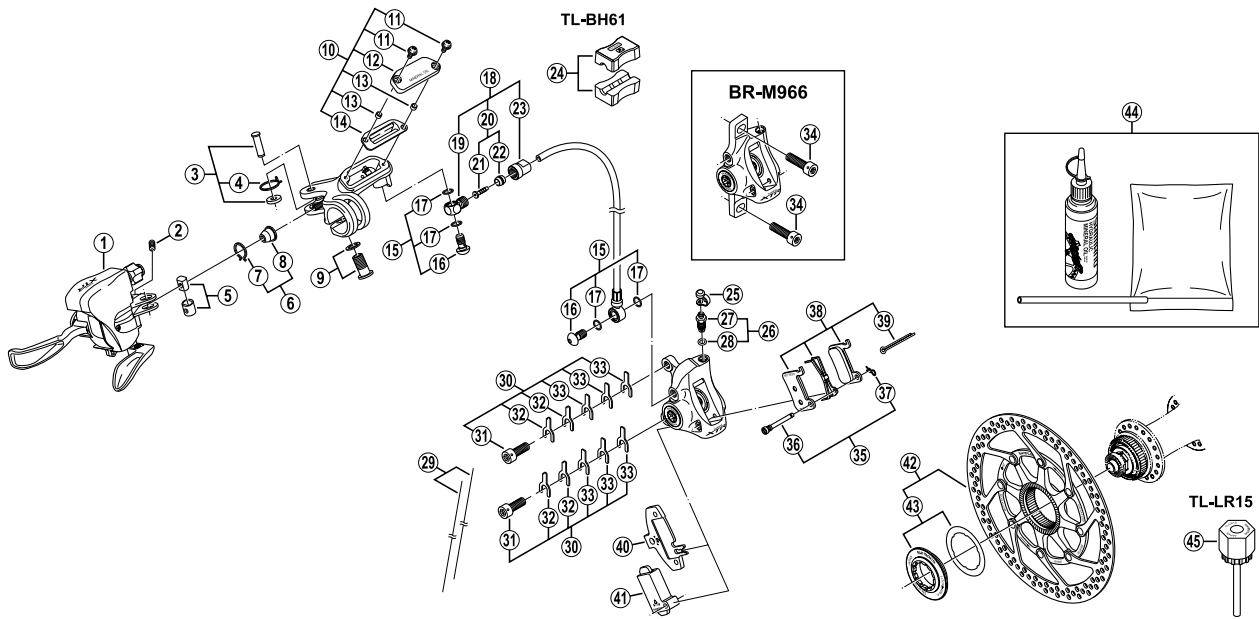

ITEM NO.	SHIMANO CODE NO.	DESCRIPTION
1	Y-6GS98020	L.H. Main Lever Assembly
2	Y-6AU84200	Lever Axle Fixing Bolt (8 mm)
3	Y-6GS98100	L.H. Lever Axle Unit
4	Y-6GS84100	L.H. Fixing Spring
* 5	Y-6JK 98070	Reach Adjusting Boss & Sleeve
6	Y-8SY 98070	Boot & Stopper
7	Y-8SY 30000	Boot Stopper
8	Y-8SY 17000	Boot
9	Y-6AU98090	Clamp Bolt (M8 x 16) & Washer
10	Y-6GS98140	L.H. Lid Unit
11	Y-8SY 24000	Lid Fixing Screw
12	Y-6GS86100	L.H. Lid
13	Y-6GS79000	Lid Spacer
14	Y-6GS85100	L.H. Diaphragm
15	Y-8H0 98010	Banjo Bolt & O-Ring
16	Y-8H0 01500	Banjo Bolt
17	Y-8SY 28000	O-Ring
18	Y-8CL 98110	Banjo Unit
19	Y-8H3 02000	Banjo A
20	Y-8H2 98020	Olive & Connecting Insert
21	Y-8H2 02000	Connecting Insert
22	Y-8H2 04000	Olive
23	Y-8H3 03000	Banjo Nut
24	Y-8H1 98030	TL-BH61 Special Tool (2 pcs.)
25	Y-8B2 14000	Bleed Nipple Cap
26	Y-8CL 98050	Bleed Nipple & Seal Ring
27	Y-8CL 24000	Bleed Nipple
28	Y-8B5 11001	O-Ring for Bleed Nipple
29	Y-8B2 98010	Wire (2 pcs.)
30	Y-8CL 98060	Caliper Fixing Bolt Unit
31	Y-8B2 17000	Caliper Fixing Bolt A (M6 x 16.5)
32	Y-8CL 13000	Spacer (0.5 mm)
33	Y-8CL 14000	Adjusting Washer (0.2 mm)
34	Y-8B2 18000	Caliper Fixing Bolt B (M6 x 21) for BR-M966
35	Y-8CL 98070	Pad Axle & Snap Ring
36	Y-8CL 11000	Pad Axle
37	Y-8B2 12000	Snap Ring
* 38	Y-8CL 98010	Metal Pad (M06) & Spring w/Split Pin
	Y-8CL 98020	Resin Pad (M07) & Spring w/Split Pin
* 39	Y-8DB06000	Split Pin
40	Y-8CL 12000	Pad Spacer
41	Y-8CL 18000	Spacer for Bleeding
42	Y-8CL 98080	Disc Rotor Unit (φ160 mm)
43	Y-8CL 98090	Lock Ring & Washer
44	Y-839 98010	Mineral Oil Bleed Kit (50 ml)
45	Y-120 09230	TL-LR15 Lock Ring Removal Tool

0408-2148C

Specifications are subject to change without notice.

**SHIMANO**