

**Air Sleeve Maintenance** See [www.foxracingshox.com](http://www.foxracingshox.com) for downloadable video instructions.

Release all air pressure from Air Valve.

Cycle shock a few times to release pressure from the air negative spring.

Release all air pressure from Air Valve again.

Remove shock from bike

Remove aluminum reducers.

Clamp shaft eyelet in a vise with soft jaws being careful not to crush the air valve, lock out lever, or rebound knob.

Slide a screwdriver or punch through the body eyelet to keep the air sleeve from coming off the body.

Loosen air sleeve by turning counter clockwise and slide it down the body.

Remove screwdriver or punch.

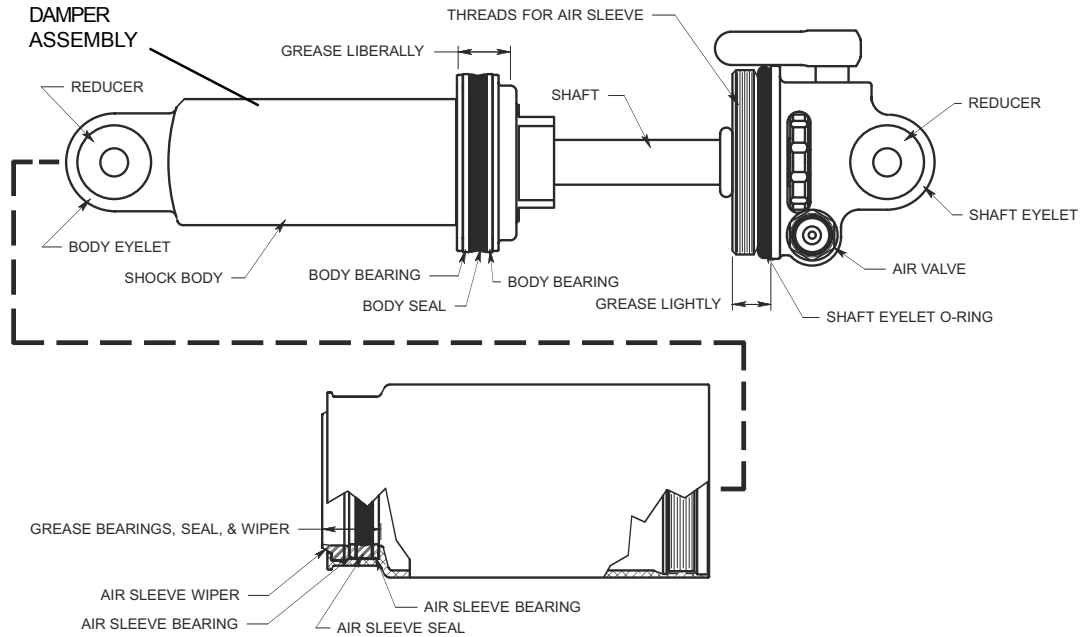

### Cleaning and Inspecting

Clean inside of the air sleeve with parts cleaner.

Inspect the seal and bearing inside of the air sleeve.

Replace if damaged or worn.

Clean body, body seal, body bearings and shaft with parts cleaner.

Inspect body seal and body bearings for wear or damage.

Replace if damaged or worn.

### Greasing and Reassembling

Lightly lube the shaft eyelet O-ring and shaft eyelet threads with FLOAT Fluid or Multi-purpose Lithium based grease (NLGI #2).

Liberaly lube the body seal and body bearing, leaving a reservoir of lube above the body bearing .

Lightly grease the air sleeve seal, air sleeve bearing, and air sleeve wiper.

Slide the air sleeve over the body until the air sleeve wiper is at the end of the body. Leave the air sleeve unthreaded at this time.

(The air sleeve will be very difficult to compress because there is pressure trapped in the air negative chamber.

Waiting until after the shock is mounted in the bike will allow the leverage of the bike to easily compress the shock.)

Dry bushings and reducers.

Install reducers in eyelet bushings.

Install shock in bike.

Carefully compress shock until you can screw on the air sleeve. Do not let the air sleeve slip off the body.

Thread air sleeve onto shaft eyelet.

Inflate shock using inflation instructions listed in the *Pump Instructions*.

*Note: If needed, the Air Sleeve Seal Kit part number is 803-00-050-B.*

*FLOAT Fluid part numbers: 025-03-002-A 5 cc Pillow Pack*

*025-03-003-A 8 oz. Bottle*